



LET has Internal Policy for Continuous Development & Reserves right to make Technical Modifications / Replacement without prior notice.

Work Add.: Gala No.09, Deevan Industrial Estate No.2A, Vasai Navghar, Vasai (East), Pincode- 401210, Maharashtra, India

Regd. Add.: A/202, Iris CHS Ltd. Central Park, Nalasopara (East)  
Dist. Palghar Pincode - 401209, Maharashtra, India

Email ID.: [info@letmanufacturing.com](mailto:info@letmanufacturing.com), [marketing@letmanufacturing.com](mailto:marketing@letmanufacturing.com)

Contact No.: 90111 32262 // 77440 67508



Linear Electromech Technology &  
Manufacturing Company

## PRODUCT CATALOGUE

### Feeding Solutions In Scientific Equipments

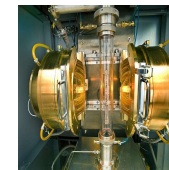

*A Scientific Equipments Manufacturing Company*



[www.letmanufacturing.com](http://www.letmanufacturing.com)

**Stability Chamber**



**Features:**

- ◆ Capacity (L) :100, 200, 400, 600,800,1000
- ◆ Temperature range: 20°C to 60°C
- ◆ Temperature Accuracy : ±0.2°C
- ◆ Humidity Range: 40% to 90%
- ◆ Humidity Accuracy : ±2%
- ◆ Uniformity : ±2°C & 3% RH
- ◆ Microprocessor based PID Controller

**Photo Stability Chamber**



**Features:**

- ◆ Capacity (L) :100, 200, 400
- ◆ Temperature range: 20°C to 60°C
- ◆ Temperature Accuracy : ±0.2°C
- ◆ Humidity Range: 40% to 90%
- ◆ Humidity Accuracy : ±2%
- ◆ Uniformity : ±2°C & 3% RH
- ◆ Microprocessor based PID Controller

**Laboratory Refrigerator**



**Features:**

- ◆ Capacity (L) :100, 200, 400, 600, 800, 1000
- ◆ Temperature range: 2°C to 8°C
- ◆ Temperature Accuracy : ±0.2°C
- ◆ Audio visual Alarm.
- ◆ Microprocessor based PID Controller
- ◆ Other customized requirements on request.

**Walk In Cold Room**



**Features:**

- ◆ Capacity (L) :8000, 10000, 12000 as per requirements
- ◆ Temperature range: 2°C to 8°C
- ◆ Temperature Accuracy : ±0.2°C
- ◆ Uniformity : ±1°C
- ◆ Audio visual Alarm.
- ◆ Microprocessor based PID Controller

**Cooling Incubator**



**Features:**

- ◆ Capacity (L) :100, 200, 400, 600, 800
- ◆ Temperature range: 5°C to 60°C
- ◆ Temperature Accuracy : ±0.2°C
- ◆ Uniformity : ±2°C
- ◆ Audio visual Alarm.
- ◆ Microprocessor based PID Controller
- ◆ Other customized requirements on request.

**Bacteriological Incubator**



**Features:**

- ◆ Capacity (L) :100, 200, 400, 600,800
- ◆ Temperature range: Amb+5°C to 60°C
- ◆ Temperature Accuracy : ±0.2°C
- ◆ Uniformity : ±2°C
- ◆ Audio visual Alarm.
- ◆ Microprocessor based PID Controller
- ◆ Other customized requirements on request



This Software is Designed as per the requirements of US FDA 21CFR Part 11

◆ **Software Control**

All Parameters can be set & easily accessible.

◆ **Data Downloading**

Data Can be Stored for Future use.

◆ **Reports & Graphs Facility.**

◆ **Real Time Access.**

◆ **Backup Facility.**

◆ **Restore.**

**Common Software for All Equipmen**

**Features:**

◆ **Secure User Login (Admin & User)**

Admin can Define User Access Rights, Access level and create New Users.

◆ **Password Protection**

Individual Password protection for all users with Alphanumeric keywords.

### Chiller Bath



**Features:**

- ◆ Capacity (L) :5, 10,15, 20, 40
- ◆ Temperature range: -20°C to 100°C
- ◆ Temperature Accuracy : ±0.2°C
- ◆ Wetted Parts SS-316
- ◆ Integrated Pump for Temp. Uniformity
- ◆ Microprocessor based PID Controller

### Heat Bath

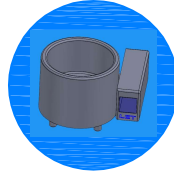

**Features:**

- ◆ Capacity (L) :1, 3, 5, 10, 20
- ◆ Temperature range: Amb+5°C to 250°C
- ◆ Temperature Accuracy : ±0.2°C
- ◆ Temperature Uniformity : ±2°C
- ◆ MOC SS-316
- ◆ Table Top
- ◆ Microprocessor based PID Controller

### Walk In Stability Chamber



**Features:**

- ◆ Capacity (L) :8000, 10000,12000 & as per requirements
- ◆ Temperature range: 20°C to 60°C
- ◆ Temperature Accuracy : ±0.2°C
- ◆ Humidity Range: 40% to 90%
- ◆ Humidity Accuracy : ±2%
- ◆ Uniformity : ±2°C & 3% RH
- ◆ Microprocessor based PID controller

### Freezer



**Features:**

- ◆ Capacity (L) : 100, 200,400, 600
- ◆ Temperature range: Upto -20°C
- ◆ Temperature Accuracy : ±0.2°C
- ◆ Audio visual Alarm.
- ◆ Microprocessor based PID Controller
- ◆ Other customized requirements on request.

### Stirring Blades

**Features:**

- ◆ MOC SS-316
- ◆ As per User Requirement.



Anchor Type



Axial Type



Helical Type



Paddle Type



Propellor Type



Radial Type

### RTD Sensors



**Features:**

- ◆ Dimension : Ø4 x 150mm long
- ◆ Other Dimensions on request
- ◆ Temperature range: -199°C to 350°C
- ◆ Temperature Accuracy : ±0.5%

### Icelined Refrigerator



**Features:**

- ◆ Capacity (L) :100, 200,300 (Both Horizontal & Vertical models)
- ◆ Temperature range: 2°C to 8°C
- ◆ Temperature Accuracy : ±0.2°C
- ◆ 12 to 24 Hrs. backup
- ◆ Microprocessor based PID Controller
- ◆ Other customized requirements on request.

### Deep Freezer



**Features:**

- ◆ Capacity (L) : 100, 200,400, 600
- ◆ Temperature range: Upto -40°C & -80°C
- ◆ Temperature Accuracy : ±0.2°C
- ◆ Audio visual Alarm.
- ◆ Microprocessor based PID Controller
- ◆ Other customized requirements on request.

### 3 Finger Clamps



**Features:**

- ◆ MOC SS-316
- ◆ As per User Requirement.

### Orbital Shaking Incubator



**Features:**

- ◆ Capacity (L) :100, 200,300
- ◆ Temperature range: 5°C to 60°C
- ◆ Shaking speed : 30 to 250 RPM
- ◆ Time set limit: Upto 99 Hrs.
- ◆ Universal Platform
- ◆ Microprocessor based PID Controller
- ◆ Other customized requirements on request.

### Icelined Freezer



**Features:**

- ◆ Capacity (L) :100, 200,300 (Both Horizontal & Vertical models)
- ◆ Temperature range: Upto -20°C
- ◆ Temperature Accuracy : ±0.2°C
- ◆ 12 to 24 Hrs. backup
- ◆ Microprocessor based PID Controller
- ◆ Other customized requirements on request.

### Hot Air Oven



#### Features:

- ◆ Capacity (L) :30, 50, 100, 200, 300
- ◆ Temperature range: Amb+10°C to 220°C
- ◆ Temperature Accuracy : ±0.2°C
- ◆ Uniformity : ±2°C
- ◆ Adjustable Wiremesh SS Trays
- ◆ Audio Visual Alarm.
- ◆ Microprocessor based PID Controller

### Vacuum Oven



#### Features:

- ◆ Capacity (L) :30, 50, 100, 150
- ◆ Temperature range: Amb+10°C to 180°C
- ◆ Temp. Accuracy : ±0.2°C
- ◆ Uniformity : ±2°C
- ◆ Vac. Guage : Digital (10-1013 mBar)  
Analogue (0 to -29 inHg OR 0 to -730mmHg)
- ◆ Audio Visual Alarm
- ◆ Microprocessor based PID Controller

### Blood Bank Refrigerator



#### Features:

- ◆ Capacity (L) : 100, 200, 400, 600, 800, 1000
- ◆ Temperature range: 2°C to 8°C
- ◆ Temperature Accuracy : ±0.2°C
- ◆ Audio visual Alarm.
- ◆ 7 days Circular Chart recorder.
- ◆ Microprocessor based PID Controller

### Platelet Incubator



#### Features:

- ◆ Capacity (L) : 125, 250, 500
- ◆ Single Agitator, 2 Agitator, 4 Agitator
- ◆ Temperature range: 22°C
- ◆ Temperature Accuracy : ±0.2°C
- ◆ Audio visual Alarm.
- ◆ 7 days Circular Chart recorder.
- ◆ Microprocessor based PID Controller

### Plasma Freezer



#### Features:

- ◆ Capacity (L) :100, 200, 400, 600, 800
- ◆ Temperature range: Ambient to -40°C
- ◆ Temperature Accuracy : ±0.2°C
- ◆ Audio visual Alarm.
- ◆ 7 days Circular Chart recorder.
- ◆ Microprocessor based PID Controller

### Ultra Plasma Freezer



#### Features:

- ◆ Capacity (L) :100, 200, 400, 600, 800
- ◆ Temperature range: Upto -80°C
- ◆ Temperature Accuracy : ±0.2°C
- ◆ Uniformity : ±1°C
- ◆ 7 days Circular Chart Recorder.
- ◆ Audio visual Alarm.
- ◆ Microprocessor based PID Controller

### Blood Donor Couch



#### Features:

- ◆ Dual Motor
- ◆ Battery Backup
- ◆ Weight Capacity upto 200 Kgs.
- ◆ Castor Wheels with Locking
- ◆ Adjust as per user Comfort.
- ◆ Remote Control

### Platelet Agitator



#### Features:

- ◆ Capacity : 36, 48 Bags
- ◆ Oscillation : 70 RPM
- ◆ Motion Failure Alarm
- ◆ Audio visual Alarm.

### Blood Collection Monitor



#### Features:

- ◆ LCD Display
- ◆ Battery Backup
- ◆ Accuracy : ±0.2 RPM
- ◆ Audio visual Alarm
- ◆ Display in Weight & Volume

### Blood Bank Scale

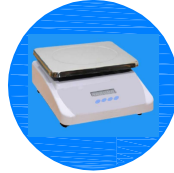

#### Features:

- ◆ Capacity :5 Kg
- ◆ Weighing Pan stainless Steel
- ◆ Accuracy : 1gm
- ◆ LCD Display
- ◆ Auto Calibration
- ◆ Microprocessor based PID controller.

### Blood Bag Tube Sealer



#### Features:

- ◆ Dielectric Radio Frequency Sealing System
- ◆ Sealing time less than 1.5 Sec.
- ◆ Frequency 40.68 Mhz
- ◆ Battery Backup

### Digital Temperature Indicator (DTI)



#### Features:

- ◆ SS-316 RTD PT-100 sensor
- ◆ Temperature range: -199°C to 400°C
- ◆ Resolution : ±0.1°C
- ◆ Ideal for monitoring true liquid temperature.